

Installation Guide

8mm Swivel Return Panel

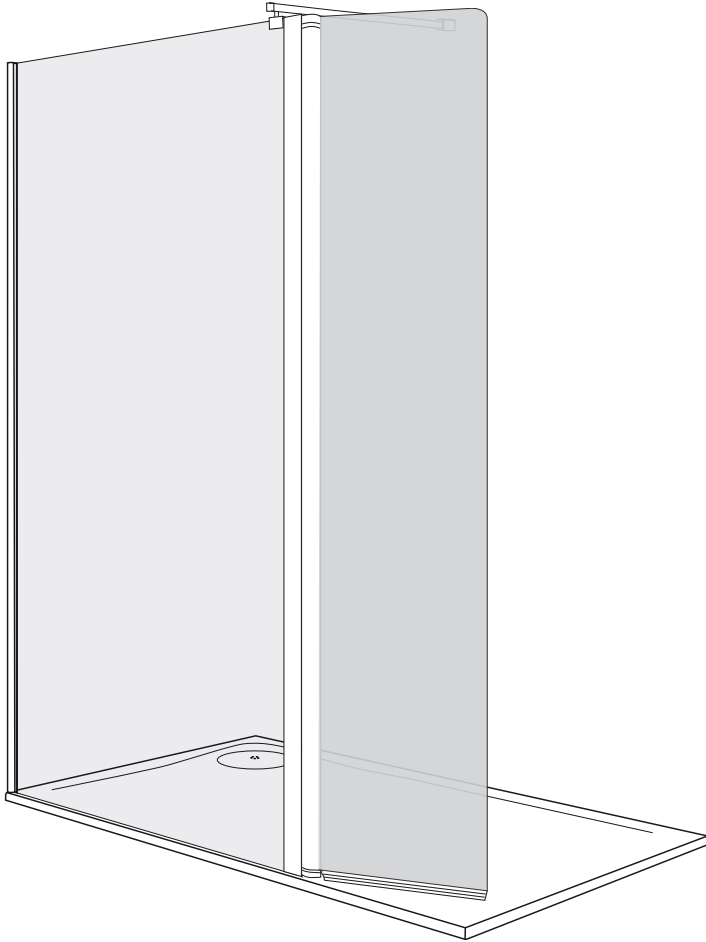

* Wetroom Screen shown for illustration purposes only.

Before you Start



Please read this installation guide fully. Although these instructions are comprehensive we always recommend that a technically competent installer undertake the installation, as incorrect fitting will invalidate the guarantee.

Unpack with care and check that the screen is the correct colour, size, shape and type you require. Ensure that you have all the parts listed as supplied. Check for any damage, **do not install if you are not satisfied** and contact your local supplier.

Ensure you have a clean dry area to work within before installing.



Important

Check your wet room screen is fully installed before fitting your Return Panel. Ensure that the floor or installed shower tray is level as the panel will not swivel correctly on an uneven surface.

Once installed do not use the shower for 24 hours to allow the silicone to fully dry.



This product is designed to be used with square or rectangular floor areas/shower trays only.



Safety Notes

Please ensure appropriate safety flooring is used in the area as it is normal for spillage to occur from the showering area.

Use safety eyewear and clothing when handling glass. Handle with care, safety glass cannot be re-worked or replaced by ordinary glass.

This product is heavy and requires a 2-person lift.

Keep small parts away from children.



Cleaning

The screen must only be cleaned with warm soapy water and a damp cloth or sponge.

Abrasive, caustic or scouring products must not be used as these will damage the surfaces of the screen.



Technical Help

Technical Service Line: 0845 505 2211 / 01684 293311 Open Mon–Fri 9am–5pm



All dimensions shown are in millimetres unless otherwise stated.

Tools and Materials Required

(not supplied)

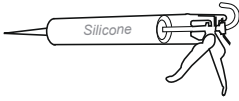

Silicone Sealant



Safety Eyewear

Parts Supplied

A

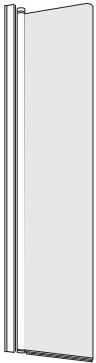

Qty 1

Fully Assembled Return Panel

B

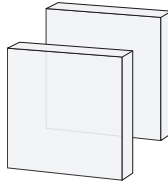

Qty 2

Plastic Glass Protectors

C



Qty 1

Glass Support (ref C)
Allen Key (ref D)

D



Qty 1

E

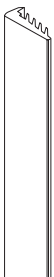

Qty 1

Bracket to Glass Seal

F

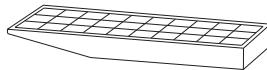

Qty 1

Glass Seal Applicator Tool

G



Qty 1

Water Deflector Seal

Installation

1

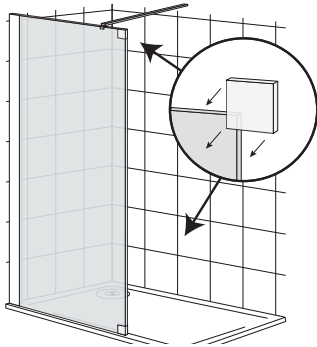

Place plastic glass protectors **B** onto top and bottom corners of the wet room glass panel. Remove any silicone from the bottom edge so that the protector **B** fits tight to the tray.

2

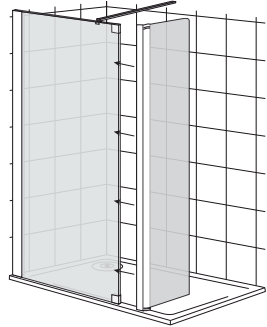

Turn the Return Panel glass **A** 90 degrees to the wet room screen. Slide the support frame onto the wet room glass panel and push firmly in place.

3

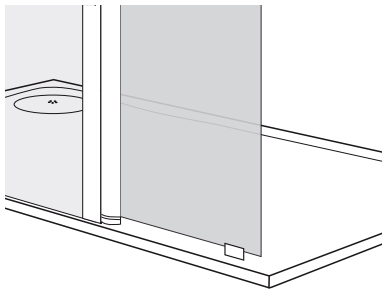

Turn the Return Panel back in line with the wet room screen. Position the Glass Support **C** on the bottom corner of the glass to ensure that the Return Panel is level.

4

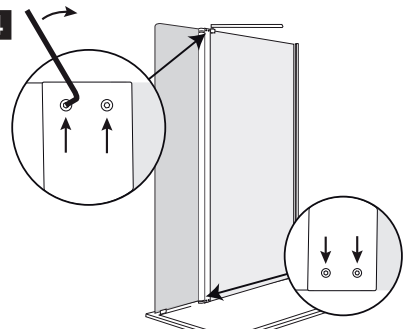

With the Allen Key **D**, firstly tighten the 2 grub screws on the top on the Return Panel bracket, followed by the 2 on the bottom of the bracket.

Installation

5

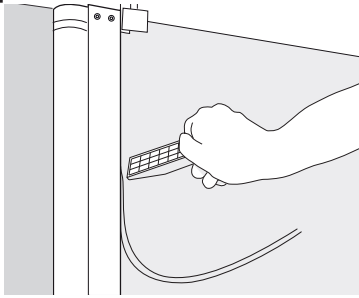

Attach the Bracket to Glass Seal strip **5** on the inside, between the glass and the aluminium frame using the Glass Seal Applicator Tool **6** provided. Simply tap the seal into place.

Note: with the angled face of the fitting tool against the glass tap the seal into place, then drag the tool down joint feeding the seal into the gap.

6

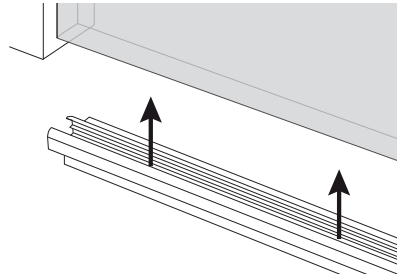

Attach the Water Deflector Seal **6** to the bottom edge of the return panel.

Note: Remove the Glass Support **3 before fitting the deflector seal.**

7

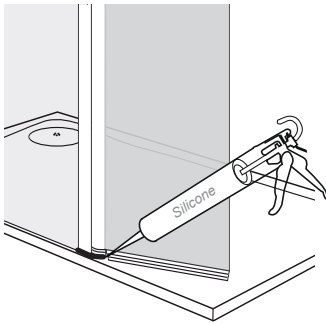

Apply a narrow bead of silicone to both sides of the bottom bracket to ensure a full seal and strong fixing to the tray.

Product supplied by the MX Group and/or its subsidiaries

Technical Service Line: **0845 505 2211 / 01684 293311** Open Mon–Fri 9am–5pm